

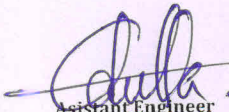

**DETAILS ESTIMATED FOR CIVIL DEFENCE QRT VEHICLE SHED AT KHARAGPUR SDO BANGALOW, INDA,
KHARAGPUR, DIST.-PASCHIM MEDINIPUR**

As per WB P.W.D Schedule of Rates

Sl no	Description of items	No	L	B	H	Qty	Total Quantity	Unit	Rate	Amount (Rs.)	
1	Surface Dressing of the ground in any kind of soil including removing vegetation inequalities not exceeding 15 cm depth and disposal of the rubbish within a lead upto 75 m as directed.	1	10.00	10.00		100.00	100.00	SqM	11.00	1100.00	
2	Earth work in excavation of foundation trenches or drains, in all sorts of soil (including mixed soil but excluding laterite or sandstone) including removing, spreading or stacking the spoils within a lead of 75 m. as directed. The item includes necessary trimming the sides of trenches, levelling, dressing and ramming the bottom, bailing out water as required complete.	1	10.00	10.00	0.30	30.00	30.00	Cum	120.47	3614.10	
3	(A) Filling in foundation or plinth by silver sand in layers not exceeding 150 mm as directed and consolidating the same by thorough saturation with water, ramming complete including the cost of supply of sand. (payment to be made on measurement of finished quantity)	1	10.00	10.00	0.15	15.00	15.00	Cum	390.29	5854.35	
4	Ordinary Cement concrete (mix 1:2:4) with graded stone chips(20 mm nominal size) excluding huttering and reinforcement,if any, in ground floor as per relevant IS codes.	1	10.00	10.00	0.10	10.00	10.00	Cum	4352.00	43520.00	
5	Asbestos corrugated (Trafford or similar approved quality)sheet (6 mm thick) work (excluding the supporting framework) fitted and fixed with 9.5mm. dia. J or L hookbolt and nuts, limpet and bitumen washers and putty with 150 mm end lap & one corrugation minimum side lap complete. (Payment should be made on area of finished work)	(a) In Roof	1	10.60	10.60		112.36	112.36	SqM	549.00	61685.64
6	3" Dia M.S. steel pipe including cutting to requisite size, fabrication with necessary metal arc welding haulage, hoisting and erection all complete. The rate includes the cost of rolled steel section, consumables such as electrodes, gas and hire charge of all tools and plants and labour required for the work including all incidental chages such as electricity charges, labour insurance charges etc. Payment to be made on the basis of calculated weight of structural tubular memembrs as specified in relevent IS code in finished work. Payment for gusset, bracket, cleat may be made by adding the actual weight of such items with weight of finished structural members. specification 6 Kg. Per Metre										
						4				4.88	19.52
						4				4.80	19.20
						4				4.73	18.92
						4				4.65	18.60
						4				4.57	18.28
										94.52	
										53.00	
										147.52	M
										0.885	MT
										68644.00	60749.94
										Total	176524.03
										Contingency	5000.00
										Total Amount =	181524.03

147.52 Metre @ 6.00 Kg/ Metre = 885 Kg.=.885 MT

Assistant Engineer
MGNREGA, Kharagpur Sub-Division

Sub-Divisional Officer
&
Deputy Controller
Civil Defence, Kharagpur, Paschim Medinipur

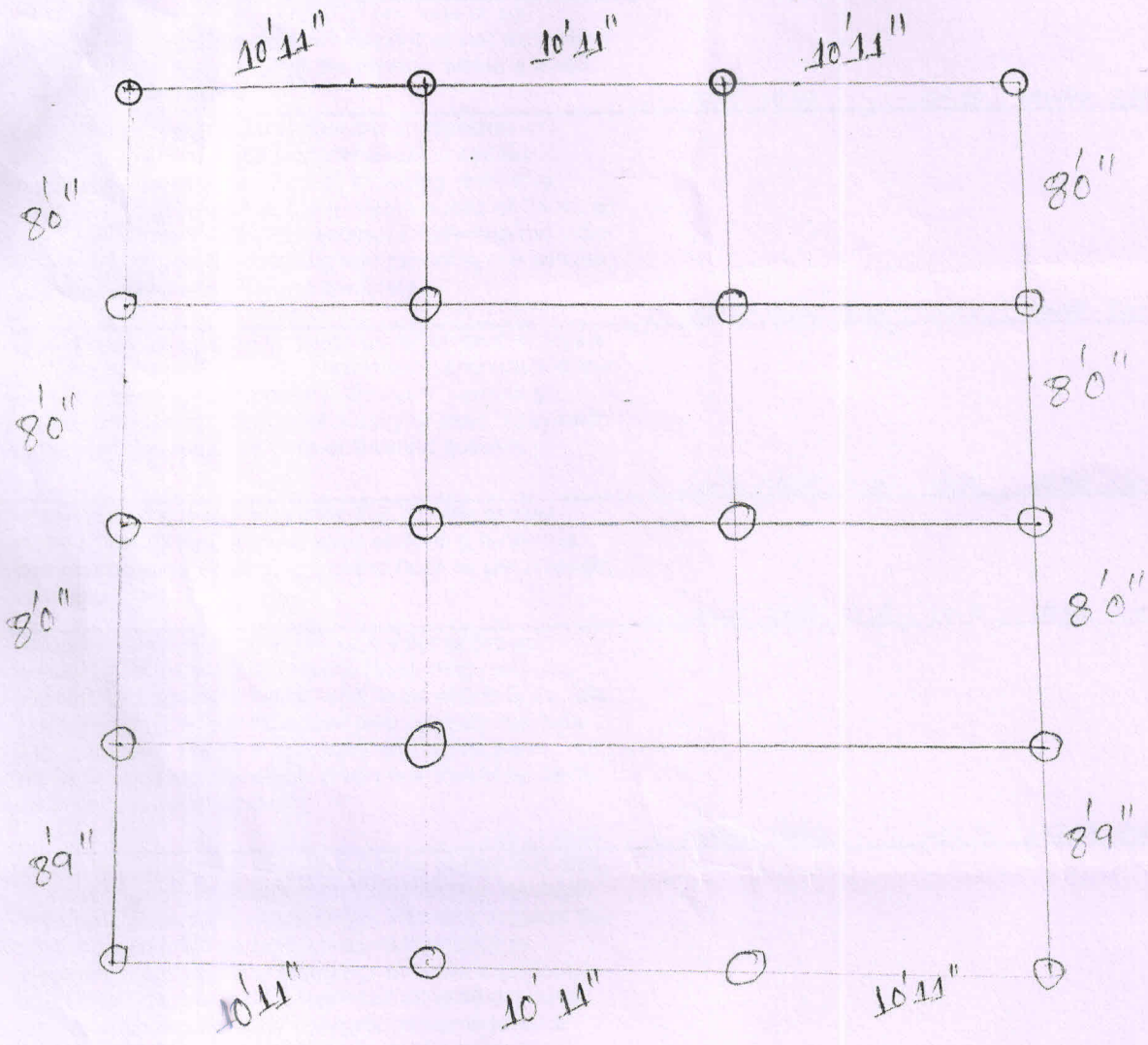

Drawing not to Scale.

[Signature]
ASSISTANT ENGINEER
MGNREGA CELL
KGP. S.D.O. OFFICE